

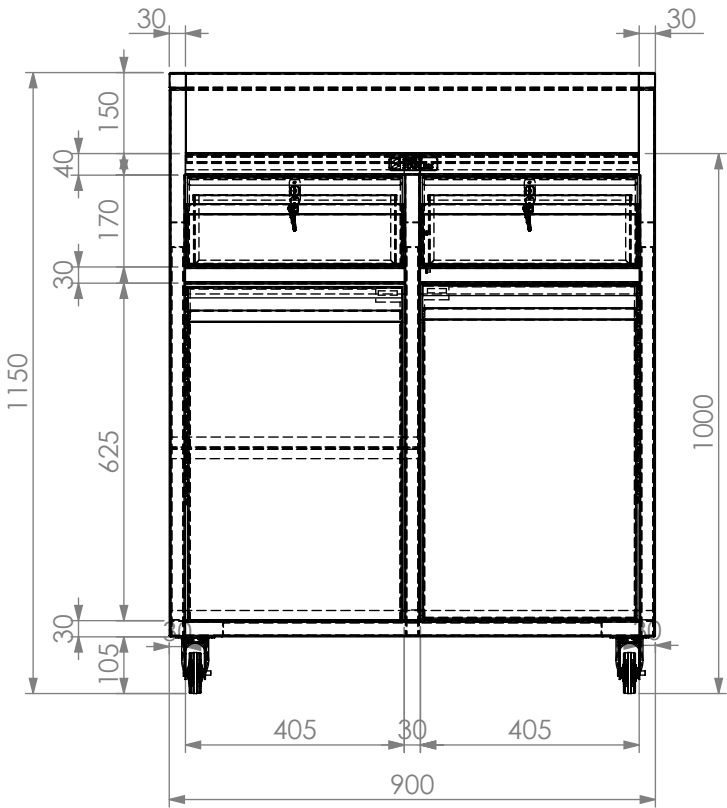

SPECIFICATION	
Tops	<div><div>- High quality stainless steel.</div><div>- 1.2mm gauge, no. 4 Finnish.</div><div>- Double skinned.</div></div>
Drawers	<div><div>- high quality stainless steel w/lock.</div><div>- 1.2mm gauge, no. 4 Finnish.</div></div>
Body	<div><div>- Full double skinned and welded construction.</div><div>- Open to RHS.</div><div>- Mid shelf to LHS.</div><div>- Double skinned doors to front.</div><div>- Full piano hinge.</div></div>
Feet	<div><div>- 4 x Castors (2x locking, 2x non locking).</div><div>- Plate mounted nylon.</div></div>



40	Waiters Station			
	Product Code	Dimensions (mm)	Unit weight (Kg)	Load capacity (Kg)
	40-WS	900x600x1150	87	160