

PLAN

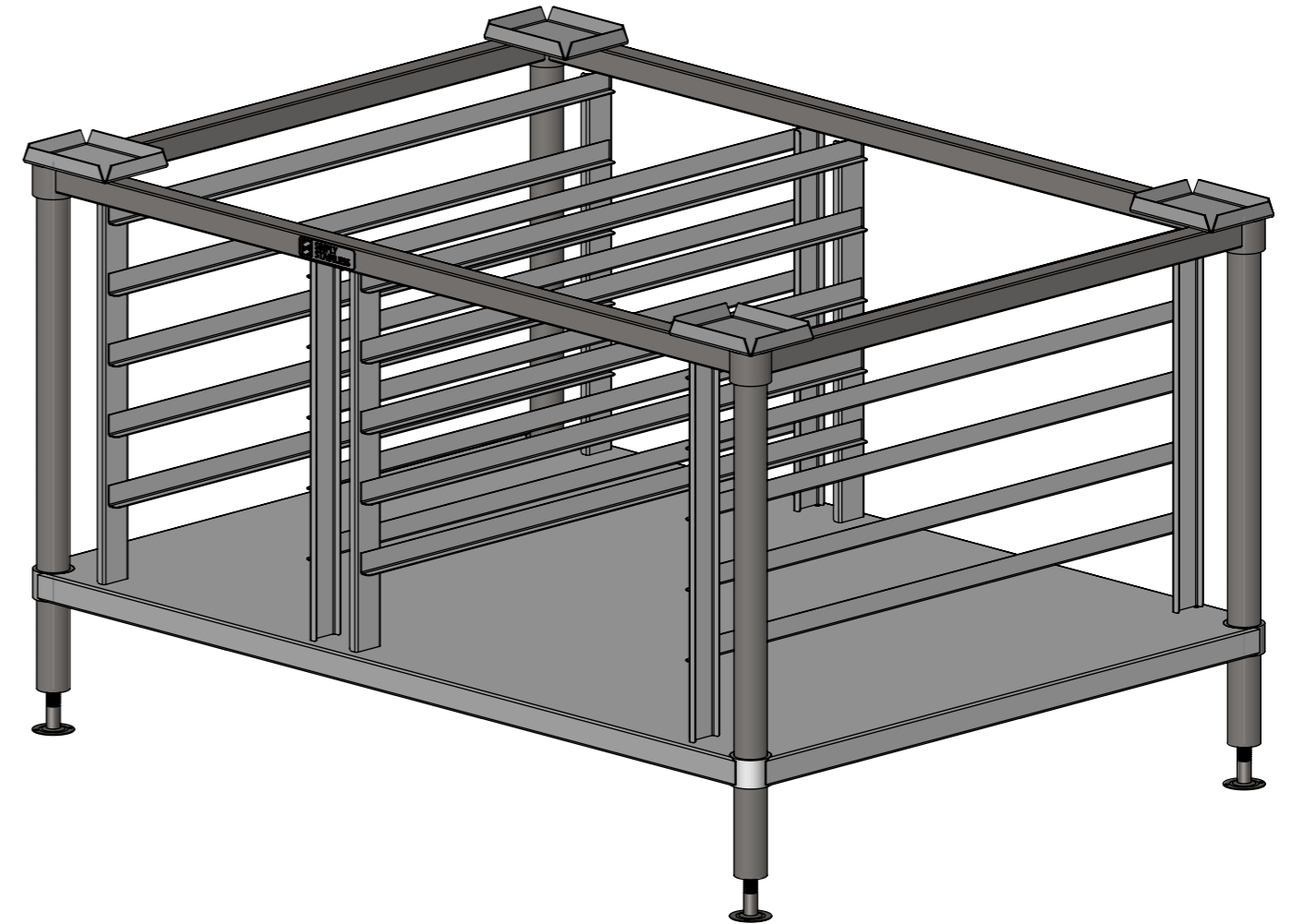

FOOT MOUNT PLATE

30x30mm SQ TUBE

CASSETTE FRAME

UNDERSHELF

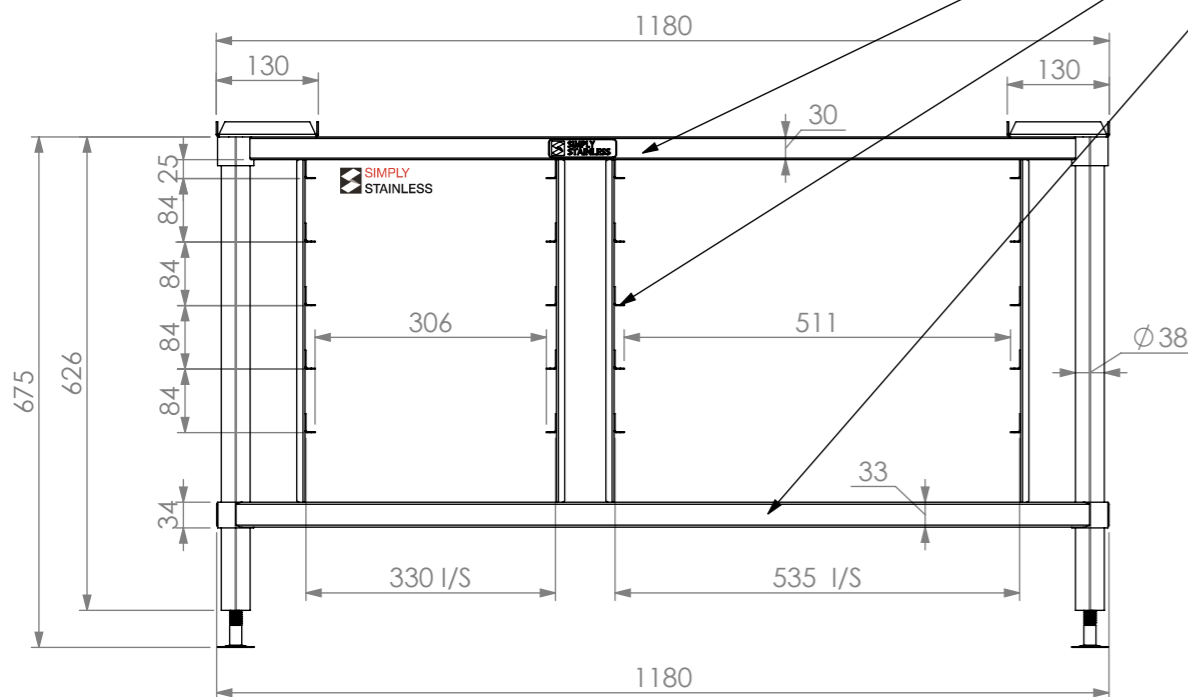

FRONT ELEVATION

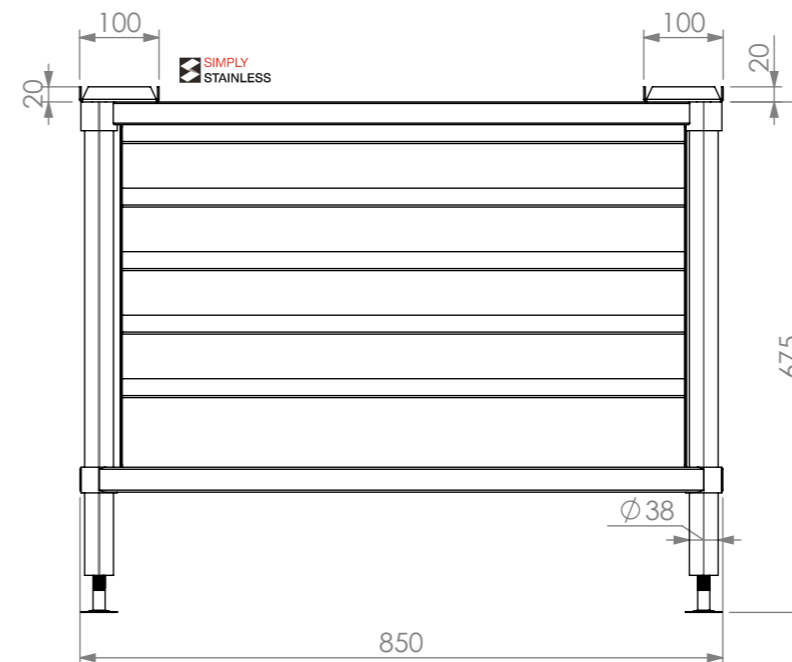

SIDE ELEVATION

27-CONV 6.20 & 10.20 STAND



www.simplystainless.com
Modular Sinks Tables and Shelving
COPYRIGHT © 2020

This drawing is the property of CI GROUP PTY LTD.
Tradings as SIMPLY STAINLESS and It may not be
copied, reproduced or modified in whole or in part
without prior written permission of CI GROUP PTY
LTD. SIMPLY STAINLESS reserves the right to
change specification and design without notice.

27-CONV 6.20 & 10.20 STAND

SIZE: A3

SCALE : 1:10

CONSTRUCTION NOTES :

1. FRAME MADE FROM Ø38mm ROUND TUBE & 30mm SQ TUBE STAINLESS STEEL.
2. UNDERSHELF MADE FROM 1.2mm STAINLESS STEEL.
3. FEET ARE ADJUSTABLE STAINLESS STEEL DISC SHAPED FEET.