

PLAN

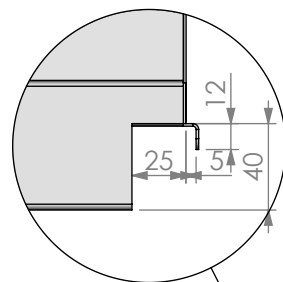

NOTCH DETAIL

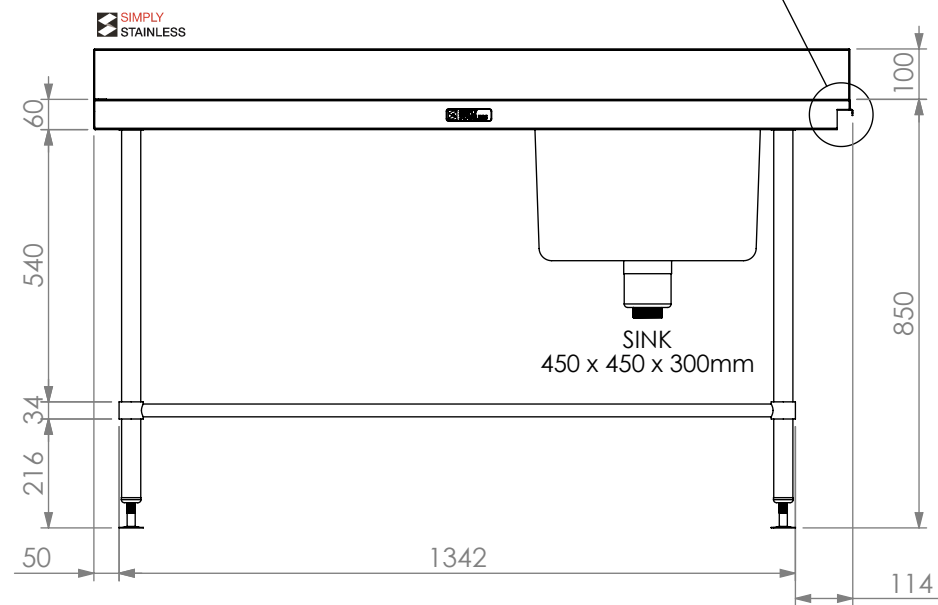

FRONT ELEVATION

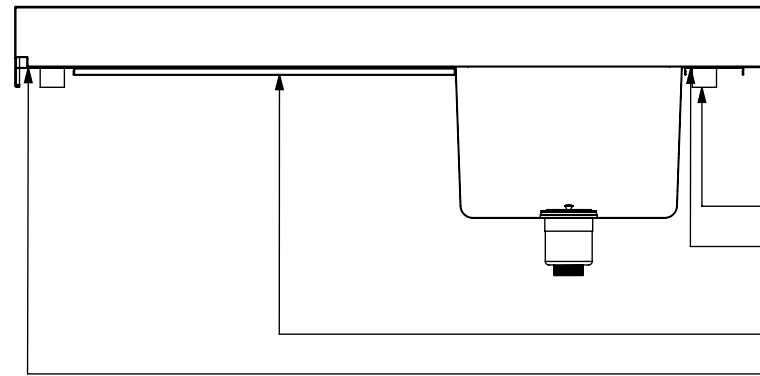
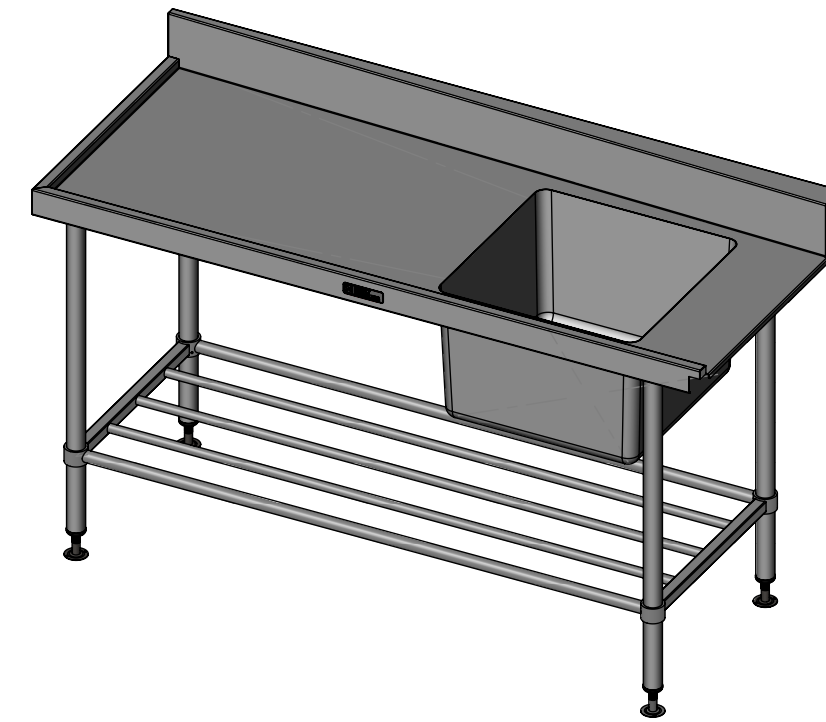

SECTION K-K

SOCKET 38mm x 48mm
 REINFORCING CHANNEL I TO PUT SOCKET
 REINFORCING CHANNEL II TO PUT SOCKET
 REINFORCING CHANNEL III TO PUT SOCKET

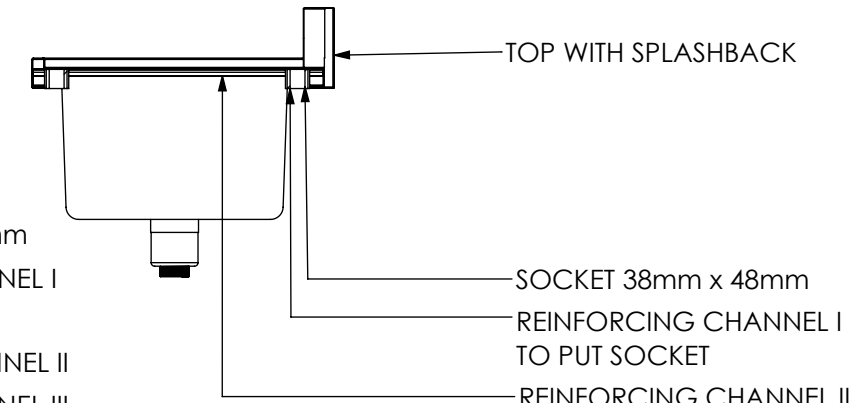

SECTION J-J

TOP WITH SPLASHBACK

SOCKET 38mm x 48mm
 REINFORCING CHANNEL I TO PUT SOCKET
 REINFORCING CHANNEL II

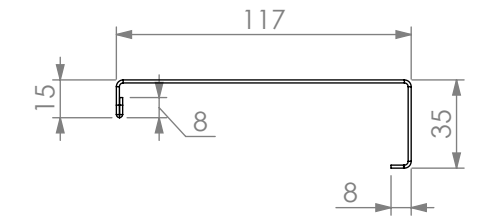

REINFORCING CHANNEL I DETAIL

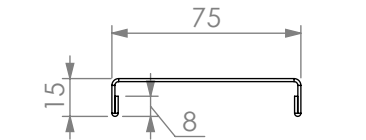

REINFORCING CHANNEL II DETAIL

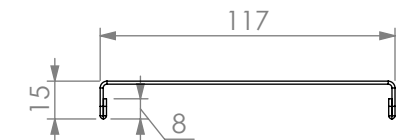

REINFORCING CHANNEL III DETAIL

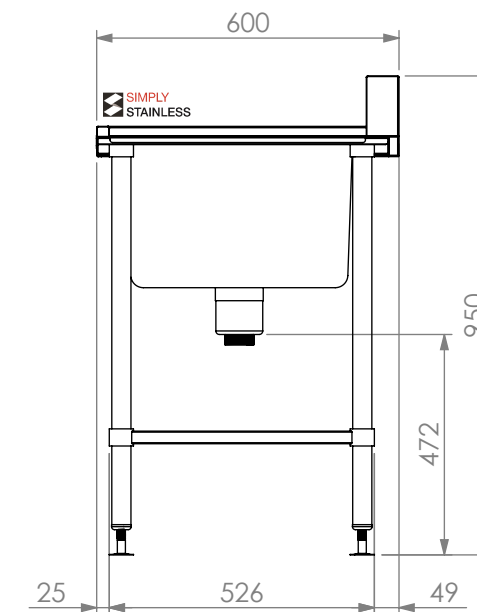

SIDE ELEVATION

SIMPLY STAINLESS
 Modular Sinks, Tables & Shelving
 COPYRIGHT © 2023
 This drawing is the property of CI GROUP PTY LTD. Tradings as SIMPLY STAINLESS and It may not be copied, reproduced or modified in whole or in part without prior written permission of CI GROUP PTY LTD. SIMPLY STAINLESS reserves the right to change specification and design without notice.

08-6-1500L
DISHWASH INLET BENCH

SIZE: A3

SCALE: 1:15

CONSTRUCTION NOTES:

1. TOPS MADE FROM 304 GRADE 1.2mm STAINLESS STEEL.
2. REINFORCING CHANNELS MADE FROM 1.2mm STAINLESS STEEL.
3. SINK MADE FROM 1.2mm STAINLESS STEEL.
4. FRAME MADE FROM Ø38mm STAINLESS STEEL TUBE.
5. POTRAIL MADE FROM STAINLESS STEEL ROUND TUBE & SQUARE TUBE.
6. FEET ARE ADJUSTABLE STAINLESS STEEL DISC SHAPED FEET.
7. WATERCORP & WATERMARK APPROVED SINK WASTE INCLUDED.

08-6-1500L

