

DETAIL B

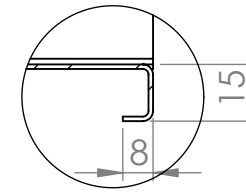

DETAIL A

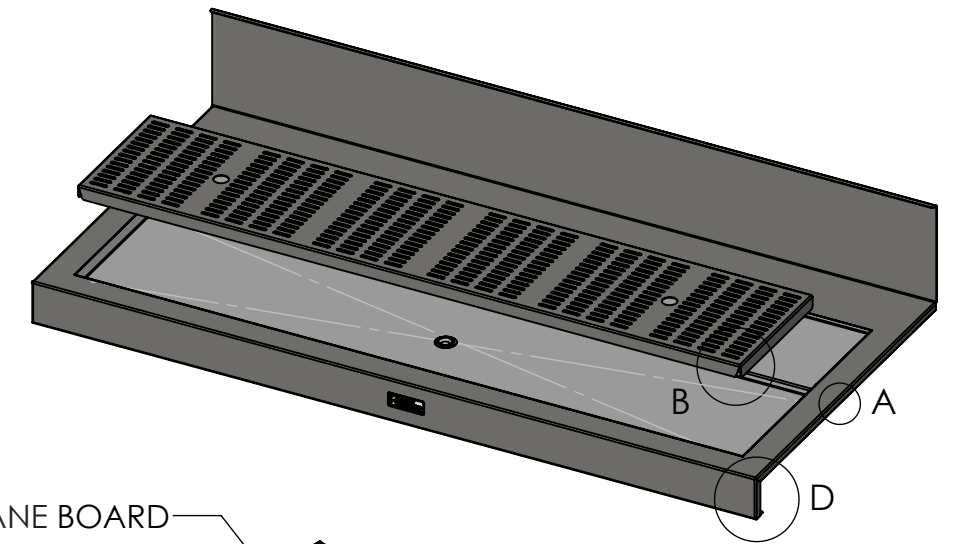

A B D

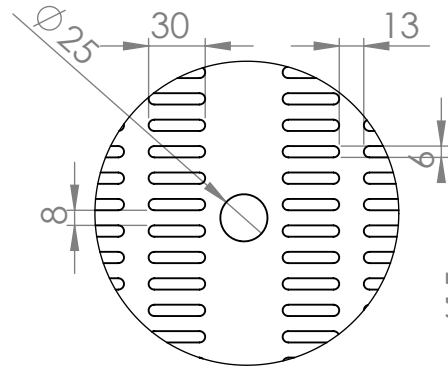

DETAIL C

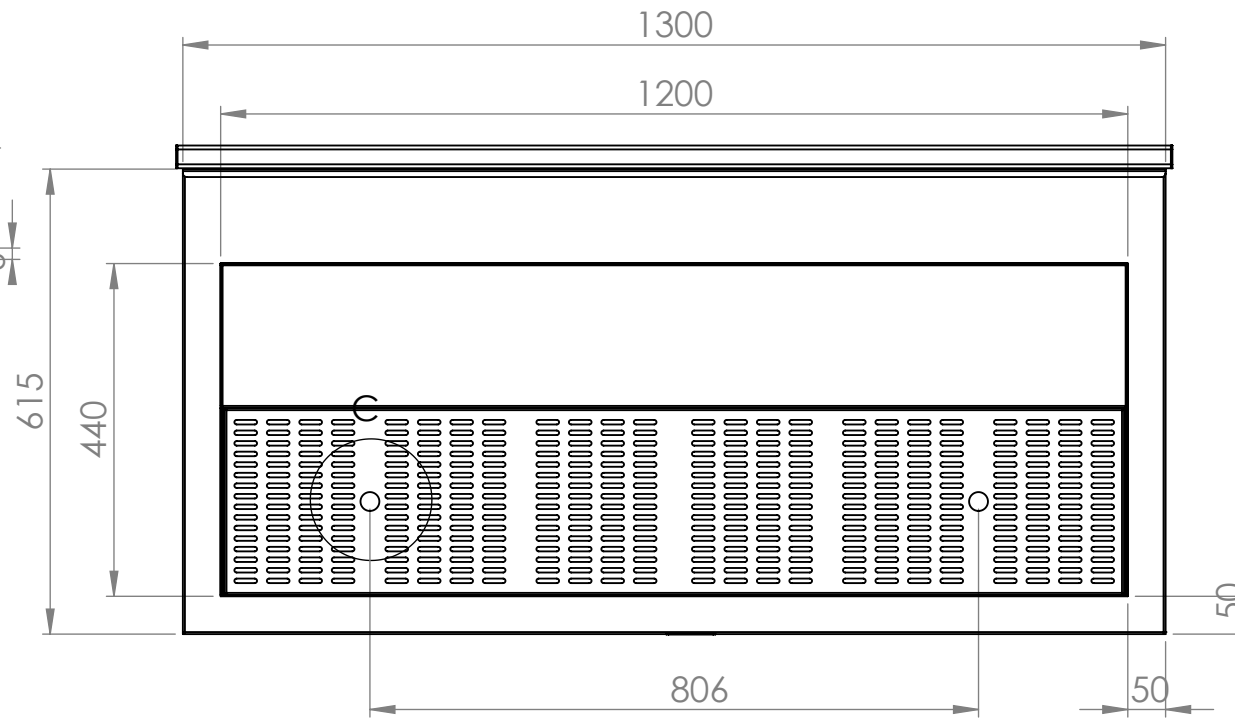

PLAN

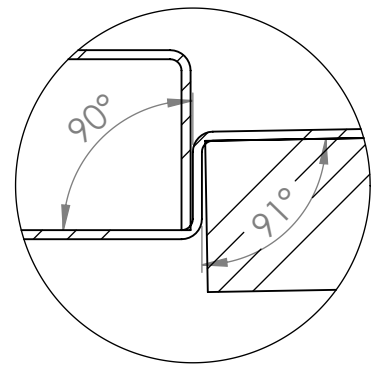

DETAIL E

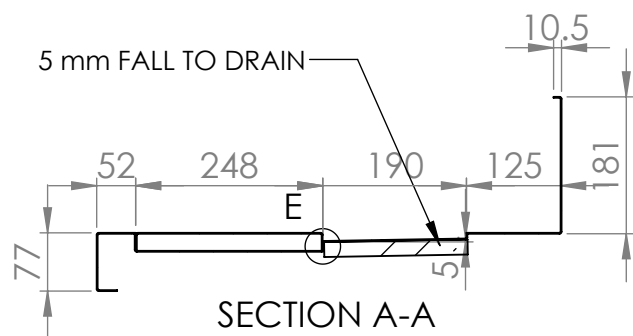

SECTION A-A

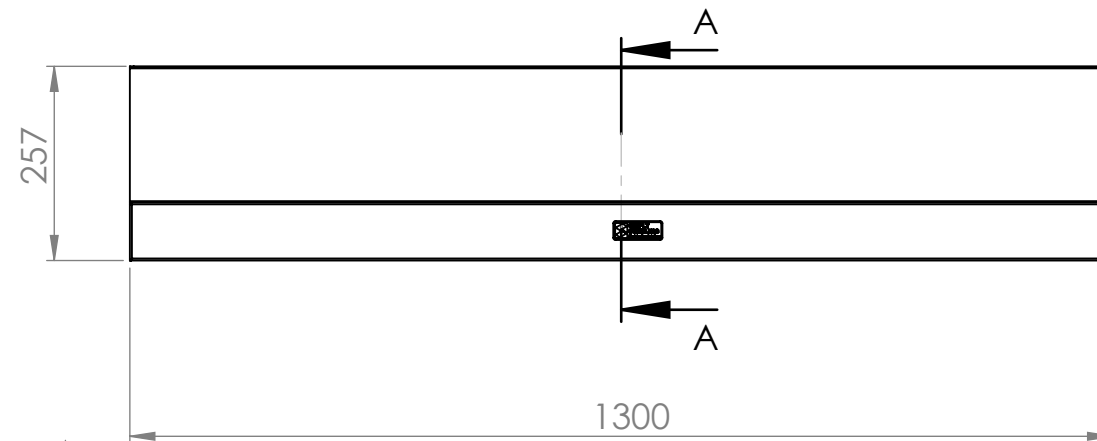

FRONT ELEVATION

SBM-BS-6-1300

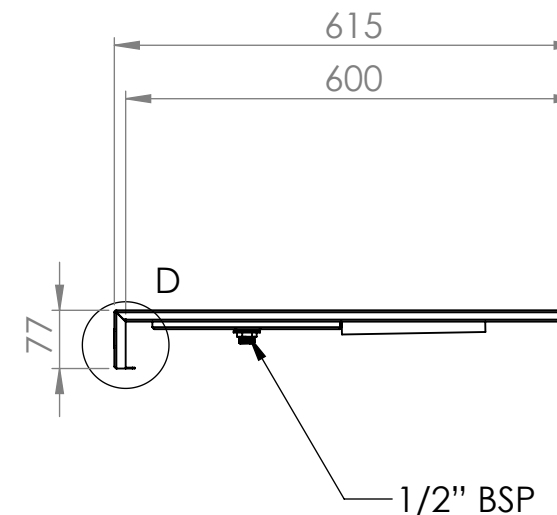

SIDE ELEVATION

POLYURETHANE BOARD

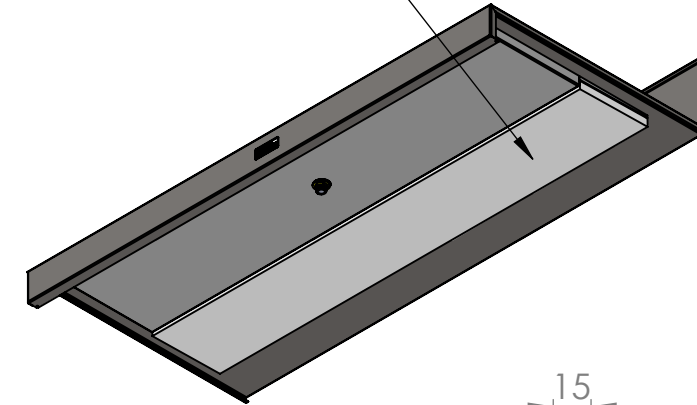

DETAIL D

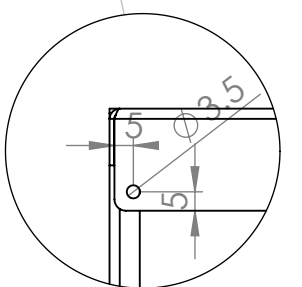
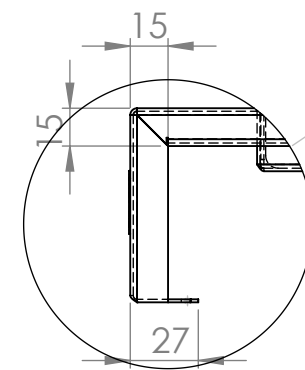
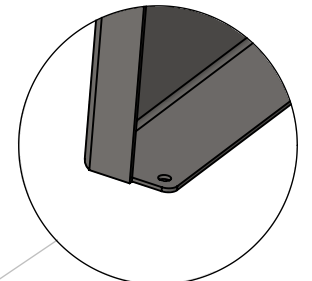

SIMPLY STAINLESS

Modular Bar Solutions

COPYRIGHT © 2023

This drawing is the property of CI GROUP PTY LTD. Tradings as SIMPLY BARS and It may not be copied, reproduced or modified in whole or in part without prior written permission of CI GROUP PTY LTD. SIMPLY BARS reserves the right to change specification and design without notice.

**SBM-BS-6-1300
BEER STATION**

SIZE: A3

SCALE: 1:10

CONSTRUCTION NOTES :

1. TOPS MADE FROM 304 GRADE, 1.2mm STAINLESS STEEL.
2. SPACER MADE FROM 30mm STAINLESS STEEL SQ TUBE.

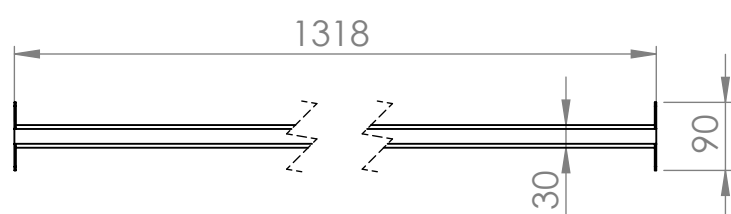

SPACER X1

